

# Real Time Fingerprint Guard Tour Probe



GTP-5000C

## Specifications

<b>Structure</b>	IMD, super wear-resistant	<b>Instruction push</b>	Real-time message
<b>Response time</b>	<0.1s	<b>Data transmission</b>	TCP/IP
<b>Reading</b>	Fingerprint/Staff card	<b>Fingerprint</b>	Optical. 255cs
<b>Screen</b>	2.4' TFT screen	<b>SOS</b>	One key send SOS alarm
<b>Installation</b>	Standard 86 junction box	<b>Size</b>	103*103*30mm
<b>Event</b>	500 pcs default	<b>Power supply</b>	12-48v

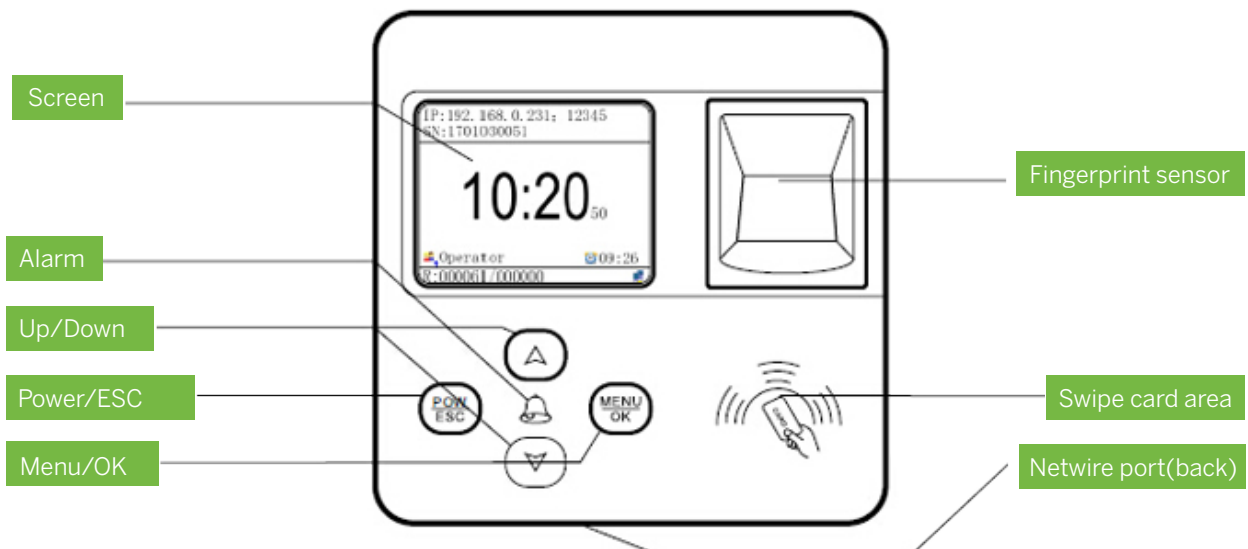

## Wiring Diagram

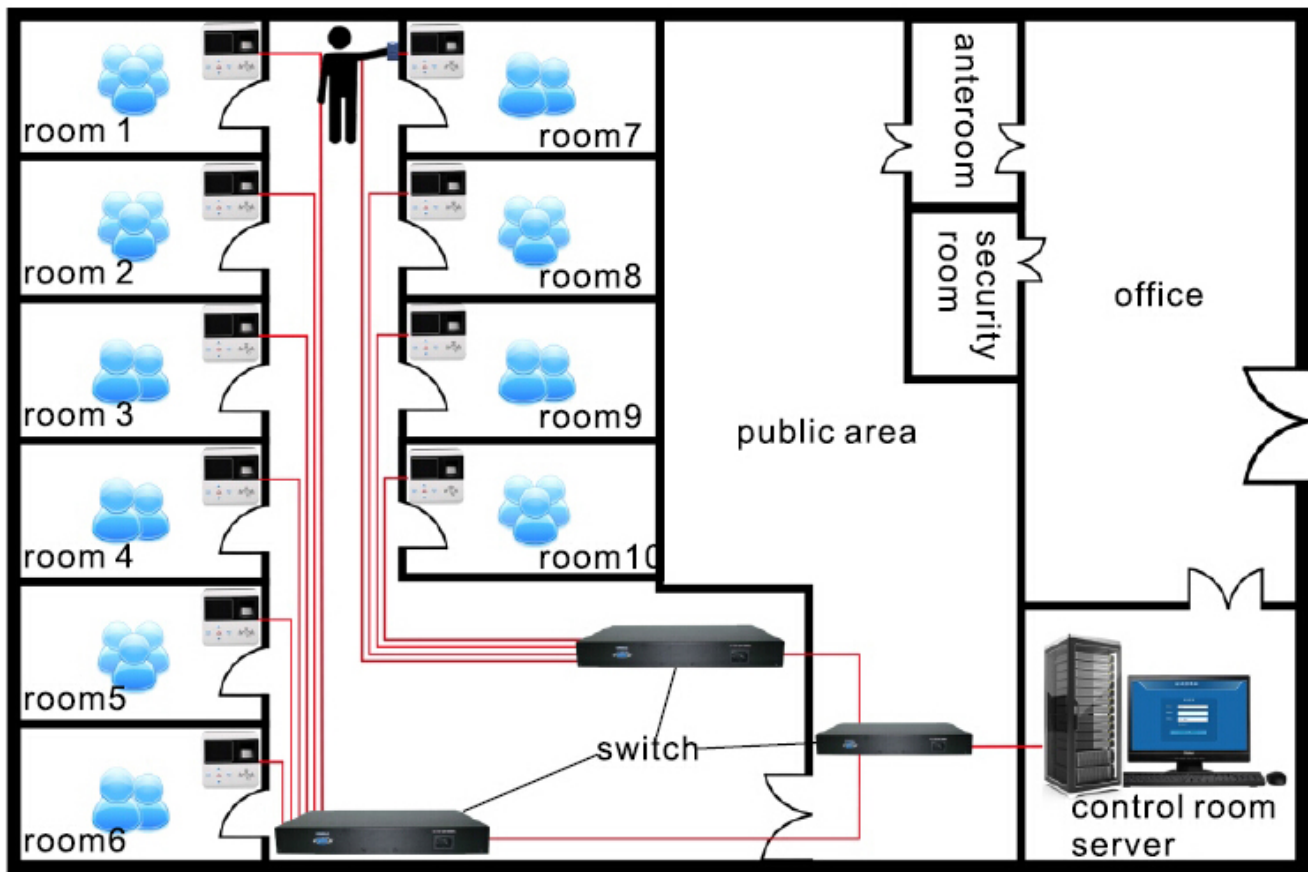

## Dimensions



S4A Industrial Co., Limited

Address: The 2nd floor, Jinmin'an Industrial Zone, #529, Bulong Rd.  
Bantian St. Longgang Dist. Shenzhen, PRC. CN 518131



Tel: +86 755 29450011

[www.s4a-access.com](http://www.s4a-access.com)